

6-GFM-250Ah

Valve-regulated Lead Acid Battery Specification

Application

- Maintenance free
- Safety and no leakage
- Excellent recharge and discharge performance
- Low self-discharge rate
- Adapt to high or low temperature
- Good deep discharge performance
- Longer cycle life



Specification

Rated Voltage	12V
Numbers of cells	6 Cells
Capacity	250Ah@10hr-rate to 1.80V per cell @25°C
Weight	70.0kg
Internal Resistance	Approx. 2.0 mΩ
Terminal	F8
Max. Discharge Current	3750A(5s)
Short Circuit Current	12500A
Max. Charging Current	62.5A
Reference Capacity	C10 250.0AH C3 191.7AH C1 138.1AH
Design Life	6~8 years
Float Charging Voltage	13.6 V~13.8 V @ 25°C Temperature Compensation: -20mV/°C/Cell
Cycle Use Voltage	14.4 V~14.9 V @ 25°C Temperature Compensation: -30mV/°C/Cell
Operating Temperature Range	Discharge: -15°C~50°C Charge: 0°C~40°C Storage: -15°C~40°C
Normal Operating Temperature Range	25°C±5°C
Self Discharge	Less than 3% at 25°C per month
Container Material	A.B.S. UL94-HB, UL94-V0 Optional.

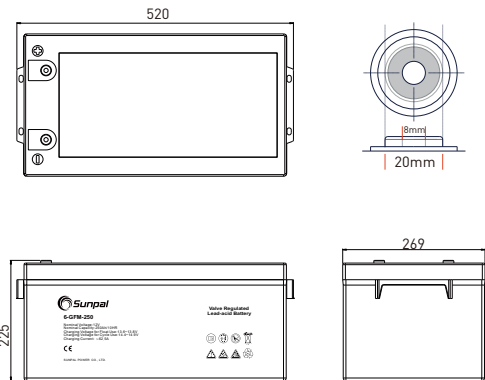

Length	520±2mm (20.5 inches)
Width	269±1mm (10.6 inches)
Height	220±1mm (8.7 inches)
Total Height	225±1mm (8.9 inches)

Constant Current Discharge Characteristics: A(25°C)

F.V/Time	5min	10min	15min	20min	30min	45min	1h	3h	5h	10h	20h
1.80V/cell	574.4	429.7	345.6	282.8	224.4	167.5	131.9	63.9	41.9	25.0	13.0
1.75V/cell	647.5	472.2	377.5	304.2	233.1	173.6	138.1	65.0	43.1	25.3	13.1
1.70V/cell	713.1	514.7	403.1	319.7	242.5	180.6	142.5	66.9	44.2	25.5	13.4
1.65V/cell	786.4	555.6	428.6	339.7	255.8	185.3	147.2	69.7	45.3	26.0	13.6
1.60V/cell	867.2	603.1	458.3	361.9	270.0	193.1	152.5	71.9	46.9	26.3	13.6

Constant Power Discharge Characteristics: WPC(25°C)

F.V/Time	5min	10min	15min	20min	30min	45min	1h	3h	5h	10h	20h
1.80V/cell	1038.9	784.7	636.4	525.3	421.1	319.2	253.3	123.9	81.9	49.4	25.7
1.75V/cell	1146.4	848.3	686.4	559.7	433.6	328.1	263.9	125.6	83.9	49.7	25.9
1.70V/cell	1227.5	903.6	722.8	583.9	448.9	340.0	271.1	128.9	85.8	50.3	26.4
1.65V/cell	1334.4	966.4	762.5	615.6	469.7	345.3	278.3	133.6	87.8	51.1	26.7
1.60V/cell	1437.8	1025.3	801.9	648.6	492.2	358.1	286.7	137.2	90.3	51.7	26.8

6-GFM-250Ah

Valve-regulated Lead Acid Battery Specification

Charge Characteristics for Float Use @ 25°C/77°F

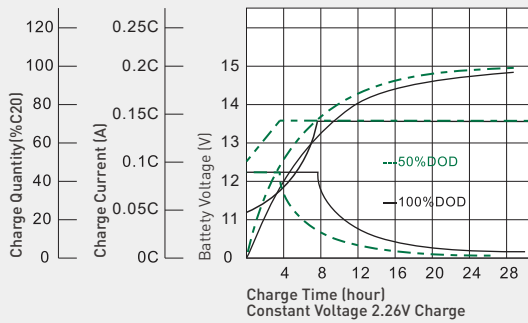

Discharge Characteristics at Various Rates @ 25°C/77°F

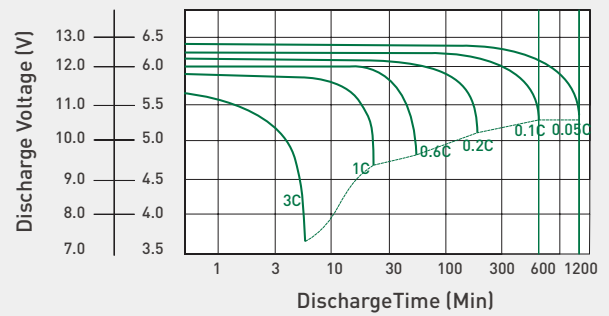

Cycle Life in Relation to Depth of Discharge

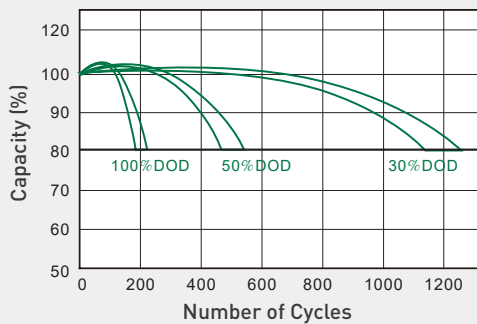

Float Service Life

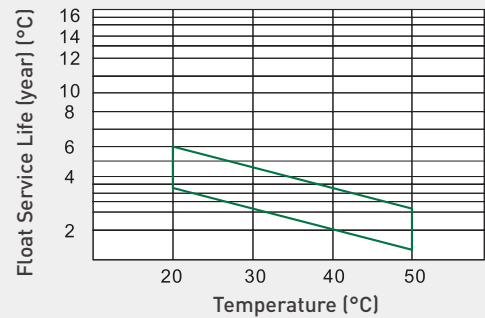

Temperature and Valid Capacity

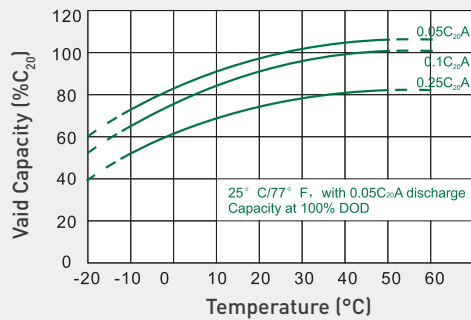

Self Discharge Characteristics

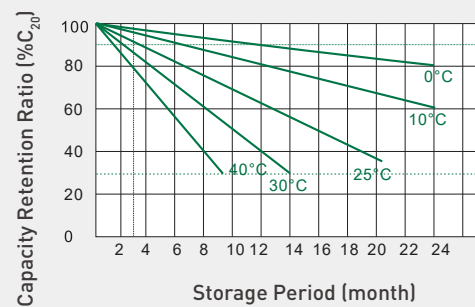

Capacity and Open Circuit Voltage

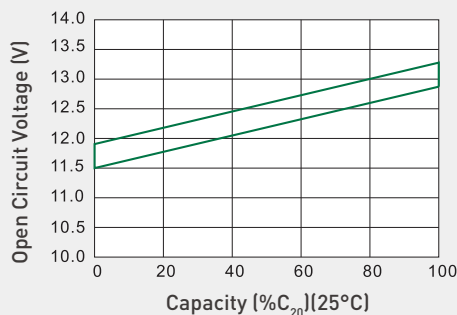

Relationship between Charging Voltage and Temperature

